

Elements: 77496 / 70496 ZEUS

Over 300 leathers and fabrics to choose from. Your choice...

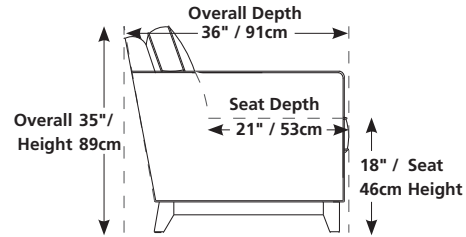

Design • It • Yourself



54" / 137cm wide
07 LHF loveseat
08 RHF loveseat

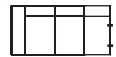

76" / 193cm wide
12 LHF sofa
13 RHF sofa



32" x 32" x 17"
81cm x 81cm x 43cm
23 angled ottoman



42" / 114cm wide
85 wedge seat 45°



46" / 117cm wide
09 corner curve



45" / 114cm wide
14 armless loveseat



89" / 226cm wide
39 LHF sofa split
40 RHF sofa split



32" / 81cm wide
88 LHF chair
89 RHF chair



23" / 58cm wide
02 freestanding armless chair

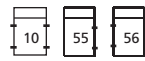

23" / 56cm wide
10 armless chair
55 LHF armless chair
56 RHF armless chair



32" x 63" x 35"
81cm x 160cm x 89cm
15 RHF chaise
16 LHF chaise



37" x 23" x 17"
94cm x 58cm x 43cm
74 rectangular ottoman

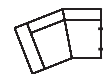

62" x 46" x 35"
157cm x 117cm x 89cm
97 LHF angled loveseat
98 RHF angled loveseat



23" x 23" x 17"
58cm x 58cm x 43cm
04 ottoman



36" / 91cm wide
11 corner square



54" x 42" x 35"
137cm x 107cm x 89cm
19 RHF bumper
20 LHF bumper



23" / 58cm wide
83 wedge seat 22°



44" x 29" x 17"
112cm x 74cm x 43cm
64 angled storage ottoman

MOST POPULAR CONFIGURATIONS

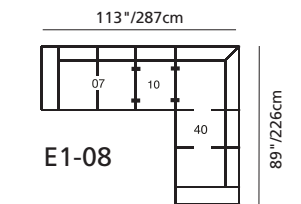
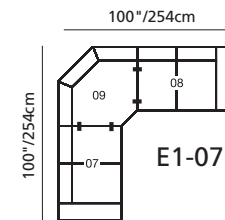
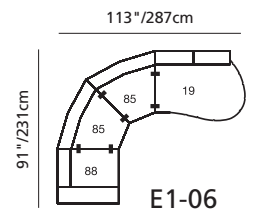
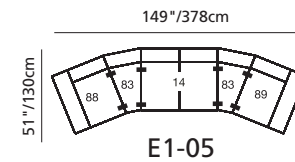
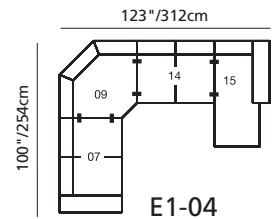
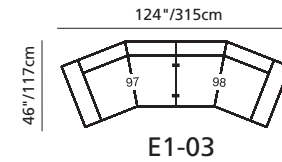
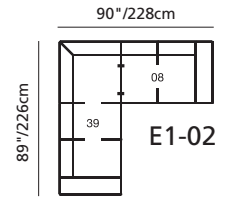
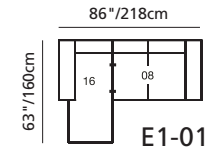

STATIONARY OPTIONS



86" / 218cm wide
01 sofa
inside arm to inside arm
= 66" / 168cm



64" / 163cm wide
03 loveseat
inside arm to inside arm
= 44" / 112cm



42" / 107cm wide
95 2-arm chair
inside arm to inside arm
= 22" / 56cm

Flexibility & CHOICE

Sit down. Stretch out. Relax.

Whether you are sipping a cappuccino all by yourself, or entertaining friends and family, **Elements** is the modular option for you! Beautiful, with clean lines and comfort to spare, this versatile collection allows you to custom design seating systems to suit your space and lifestyle.

These modular components have been engineered to connect together seamlessly, to allow for an infinite number of seating options. Here are just some of the possibilities you can create using the base elements. The results are stylish and multipurpose – providing you with the ultimate in functional solutions.

1

Choose your style

2

Choose your configuration

3

Choose your cover
over 300 leathers & fabrics

4

Choose your leg finish color

OR

Visit palliser.com
and click on the Room Builder box
to create your own configuration
to fit your home perfectly.