

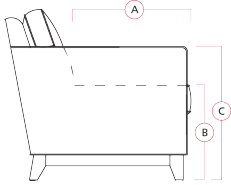

77332 MARYMOUNT

Dimensions shown as Width x Depth x Height. Specifications are correct at time of printing and are subject to change without notice.
LHF - left hand facing RHF - right hand facing IA - inside arm to inside



Dimensions

- A - Seat Depth - 22" / 56cm
- B - Seat Height - 21" / 53cm
- C - Arm Height - 26.5" / 67cm

Features

- Hardwood, softwood and engineered wood products; all joints pinned & glued for uniformity & strength
- Back: Premium elastic webbing offers consistent suspension for the life of the product
- Seat: Interwoven 100% elastic webbing offers consistent suspension for the life of the product
- Back filled with blown fibre

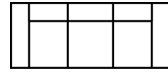

01 Sofa
83 x 38 x 34"
211 x 97 x 86cm
IA: 69" / 175cm



02 Chair
37 x 38 x 34"
94 x 97 x 86cm
IA: 23" / 58cm

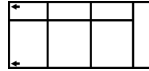

03 Loveseat
60 x 38 x 34"
152 x 97 x 86cm
IA: 46" / 117cm



04 Ottoman
23 x 23 x 17"
58 x 58 x 43cm

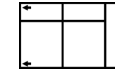

08 RHF Loveseat
07 LHF Loveseat
53 x 38 x 34"
135 x 97 x 86cm

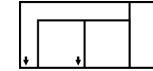

09 Corner Curve
49 x 49 x 34"
124 x 124 x 86cm

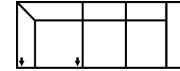

10 Armless Chair
23 x 38 x 34"
58 x 97 x 86cm

13 RHF Sofa
12 LHF Sofa
76 x 38 x 34"
193 x 97 x 86cm

14 Armless Loveseat
46 x 38 x 34"
117 x 97 x 86cm

15 RHF Chaise
16 LHF Chaise
31 x 60 x 34"
79 x 152 x 86cm

35 RHF Corner Chaise
36 LHF Corner Chaise
83 x 38 x 34"
211 x 97 x 86cm

40 RHF Sofa Split
39 LHF Sofa Split
90 x 38 x 34"
229 x 97 x 86cm



77332 MARYMOUNT

Popular Configurations

Note: Always assemble configurations from right hand facing to left hand facing components.

How We Measure

Height - measured from the highest point of the back pillow to the floor.

Depth - measured from the front edge of the seat cushion to the top of the back.

Width - measured from the widest point of the arm or arm pillow to the widest point of the opposite arm or arm pillow.

Arm Height - measured from the top of the arm to the floor.

Seat Height - measured from the crown of the seat cushion to the floor.

Warranty

Wood Frames, Springs or Webbing - ten year warranty

Metal Frames - two year warranty under normal household use

Motion Reclining Mechanisms - seven year warranty

Reclining Chairs, Sofabed Mechanisms and Sofabed Mattresses - two year warranty

Seat Cushion Foam and Fibre-filled Components - five year pro-rated warranty

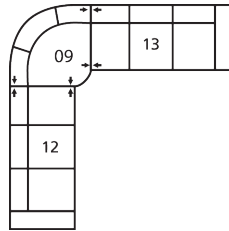

CONFIGURATION CA

125 x 125"
318 x 318cm

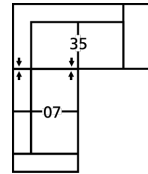

CONFIGURATION CE

91 x 83"
231 x 211cm

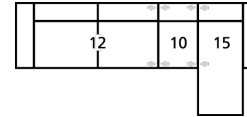

CONFIGURATION CF

130 x 60"
330 x 152cm

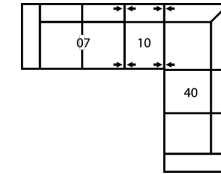

CONFIGURATION CH

114 x 89"
290 x 226cm

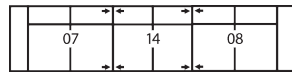

CONFIGURATION CK

198 x 38"
503 x 97cm

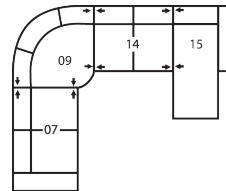

CONFIGURATION C4

126 x 102"
320 x 259cm

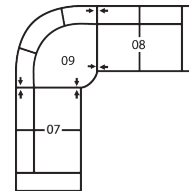

CONFIGURATION C7

102 x 102"
259 x 259cm

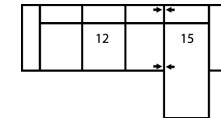

CONFIGURATION C8

107 x 60"
272 x 152cm

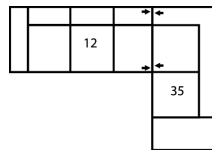

CONFIGURATION C9

114 x 83"
290 x 211cm

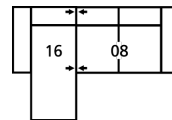

CONFIGURATION C1

84 x 60"
213 x 152cm

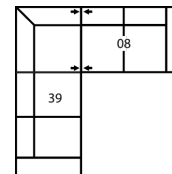

CONFIGURATION C2

91 x 89"
231 x 226cm