



Standard Features:

- **Boxed Pillow Top Seating** - Finished with generously padded box cushions and topped with a plush pillow of soft padding for added comfort.
- **ComfortRest®** - Provides continuous leg support when reclined.
- **Wallaway®** - Fully reclines with only inches of wall clearance.
- **EasyOff Backs** - Removable back for easier delivery and moving from room to room.

Optional Features:

- **ButtKicker®** - Silent subwoofer in seat that allows viewers to feel powerful bass without excessive volume.
- **Lighted Cupholder** - Generously sized to hold most cans, bottles and drink cups. Lighted ring illuminates the cupholder from the inside.
- **TouchMotion®** - Easily reclines at the touch of a button.
- **PowerRecline®** - Effortlessly recline to your favorite position.

STRAIGHT

3900 - Straight Arm RF/LF, WAW®, TM®, Rec
3901 - Straight Arm RF/LF, WAW®, PR®, Rec
H. 41.5" W. 34" SD. 22" OD. 37.5"

5200 - Straight Arm RF, WAW®, TM®, Rec
5201 - Straight Arm RF, WAW®, PR®, Rec
H. 41.5" W. 28.75" SD. 22" OD. 37.5"

5300 - Straight Arm LF, WAW®, TM®, Rec
5301 - Straight Arm LF, WAW®, PR®, Rec
H. 41.5" W. 28.75" SD. 22" OD. 37.5"

5400 - Armless, WAW®, TM®, Rec
5401 - Armless, WAW®, PR®, Rec
H. 41.5" W. 23.5" SD. 22" OD. 37.5"

6700 - Armless, WAW®, TM®, Love Seat
6701 - Armless, WAW®, PR®, Love Seat
H. N/A W. N/A SD. N/A OD. N/A

CURVED

5240 - LF Wedge Arm/RF Straight Arm, WAW®, TM®, Rec
5241 - LF Wedge Arm/RF Straight Arm, WAW®, PR®, Rec
H. 41.5" W. 36.75" SD. 22" OD. 37.5"

5340 - Wedge Arm RF/LF Straight Arm, WAW®, TM®, Rec
5341 - Wedge Arm RF/LF Straight Arm, WAW®, PR®, Rec
H. 41.5" W. 36.75" SD. 22" OD. 37.5"

5440 - Wedge Arm RF, WAW®, TM®, Rec
5441 - Wedge Arm RF, WAW®, PR®, Rec
H. 41.5" W. 31.5" SD. 22" OD. 37.5"

Available in fabric, suede, vinyl, 100% genuine top grain leather or LeatherPlus.*

* LeatherPlus combines leather and vinyl for value and comfort.

©2008 Berkline, LLC
 Specifications accurate at time of printing.
 Specifications are subject to change without notification.
 Revised 12/09.

WAW® = Wallaway®
 TM® = TouchMotion®
 PR® = PowerRecline®
 REC = Recliner



41.5" BACK HEIGHT ON ALL PIECES

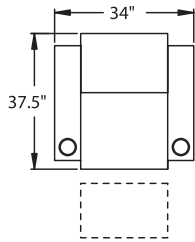

3900 RECLINER
3901 POWER

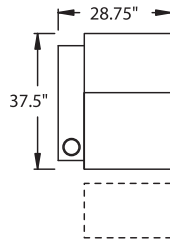

5300 LF ARM
RECLINER
5301 LF ARM
POWER

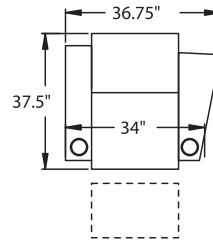

5340 LF ARM
CONSOLE RF
5341 POWER

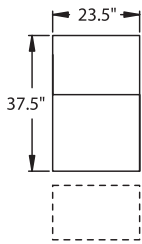

5400 ARMLESS
RECLINER
5401 ARMLESS
POWER

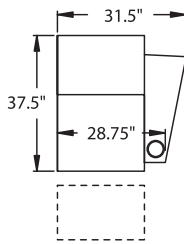

5440 CONSOLE RF
5441 POWER

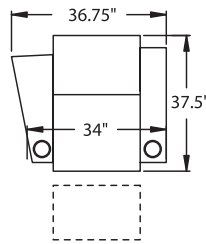

5240 LF ARM
CONSOLE RF
5241 POWER

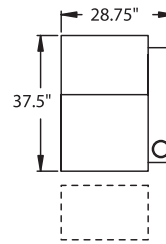

5200 RF ARM
RECLINER
5201 RF ARM
POWER

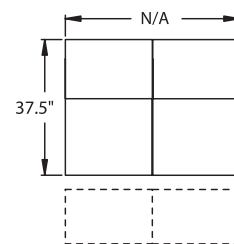

6700 ARMLESS LOVESEAT
6701 ARMLESS POWER

