

Dimensions

- A - Seat Depth - 22" / 56cm
- B - Seat Height - 21" / 53cm
- C - Arm Height - 26.5" / 67cm

Features

- Hardwood, softwood and engineered wood products; all joints pinned & glued for uniformity & strength
- Back: Premium elastic webbing offers consistent suspension for the life of the product
- Seat: Interwoven 100% elastic webbing offers consistent suspension for the life of the product
- Back filled with blown fibre

77509 MEADOWRIDGE

Dimensions shown as Width x Depth x Height. Specifications are correct at time of printing and are subject to change without notice.
LHF - left hand facing RHF - right hand facing IA - inside arm to inside

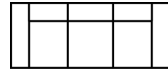

01 Sofa
86 x 38 x 36"
218 x 97 x 91cm
IA: 69" / 175cm



02 Chair
40 x 38 x 36"
102 x 97 x 91cm
IA: 23" / 58cm

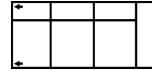

03 Loveseat
64 x 38 x 36"
163 x 97 x 91cm
IA: 46" / 117cm



04 Ottoman
23 x 23 x 17"
58 x 58 x 43cm

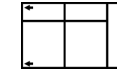

08 RHF Loveseat
07 LHF Loveseat
55 x 38 x 36"
140 x 97 x 91cm

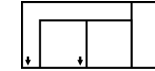

09 Corner Curve
49 x 49 x 36"
124 x 124 x 91cm

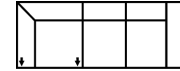

10 Armless Chair
24 x 38 x 36"
61 x 97 x 91cm

13 RHF Sofa
12 LHF Sofa
78 x 38 x 36"
198 x 97 x 91cm

14 Armless Loveseat
47 x 38 x 36"
119 x 97 x 91cm

15 RHF Chaise
16 LHF Chaise
32 x 60 x 36"
81 x 152 x 91cm

35 RHF Corner Chaise
36 LHF Corner Chaise
83 x 38 x 36"
211 x 97 x 91cm

40 RHF Sofa Split
39 LHF Sofa Split
90 x 38 x 36"
229 x 97 x 91cm



77509 MEADOWRIDGE

Popular Configurations

Note: Always assemble configurations from right hand facing to left hand facing components.

How We Measure

Height - measured from the highest point of the back pillow to the floor.

Depth - measured from the front edge of the seat cushion to the top of the back.

Width - measured from the widest point of the arm or arm pillow to the widest point of the opposite arm or arm pillow.

Arm Height - measured from the top of the arm to the floor.

Seat Height - measured from the crown of the seat cushion to the floor.

Warranty

Wood Frames, Springs or Webbing - ten year warranty

Metal Frames - two year warranty under normal household use

Motion Reclining Mechanisms - seven year warranty

Reclining Chairs, Sofabed Mechanisms and Sofabed Mattresses - two year warranty

Seat Cushion Foam and Fibre-filled Components - five year pro-rated warranty

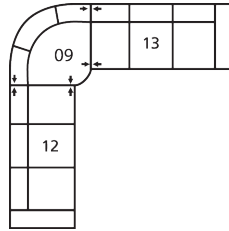

CONFIGURATION CA

127 x 127"

323 x 323cm

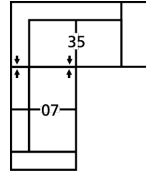

CONFIGURATION CE

138 x 38"

351 x 97cm

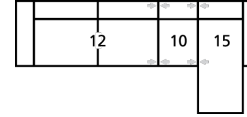

CONFIGURATION CF

134 x 60"

340 x 152cm

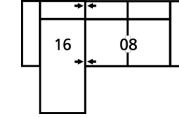

CONFIGURATION C1

88 x 60"

224 x 152cm

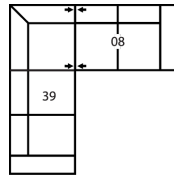

CONFIGURATION C2

93 x 91"

236 x 231cm

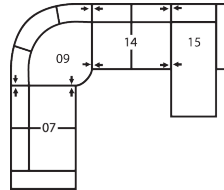

CONFIGURATION C4

128 x 104"

325 x 264cm

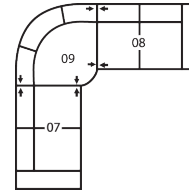

CONFIGURATION C7

104 x 104"

264 x 264cm

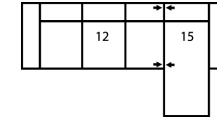

CONFIGURATION C8

110 x 60"

279 x 152cm

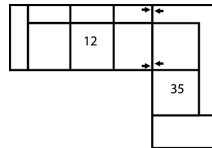

CONFIGURATION C9

161 x 38"

409 x 97cm